

**501** ← # patte /Leg

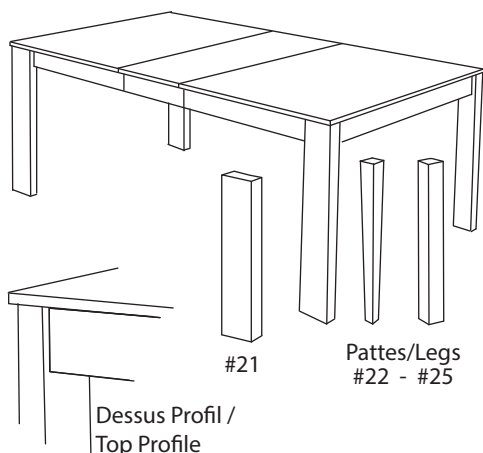

## TABLE

Table rectange en merisier massif  
 Solid birch rectangular table

**401 / 402 / 405**  
**401-2 / 402-2 / 405-2**  
**501 / 502 / 505**  
**501-2 / 502-2 / 505-2**  
**601 / 602 / 605**  
**601-2 / 602-2 / 605-2**

LARGEUR WIDTH	LONGUEUR LENGTH	EXTENSION LEAF	2 EXTENSIONS 2 LEAVES	HAUTEUR HEIGHT
36"	48"	60"		30"
36"	48"	60"	72"	30"
38"	54"	72"		30"
38"	54"	72"	90"	30"
40"	60"	80"		30"
40"	60"	80"	100"	30"

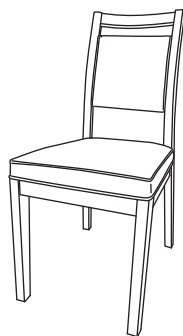

## CHAISES / CHAIRS

Chaise en bois merisier massif / dos rembourré / coussin 2"  
 Solid birch wood chair / padded back / cushion 2"

**1120**

LARGEUR WIDTH	PROFONDEUR DEPTH	HAUTEUR HEIGHT
18"	21 <sup>1</sup> / <sub>2</sub> "	39 <sup>1</sup> / <sub>2</sub> "

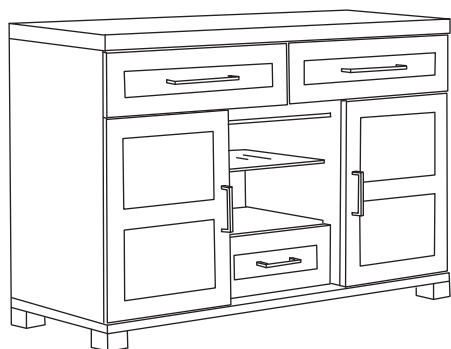

## BUFFET

Buffet entièrement en placage merisier / 3 tiroirs "coulisses quatre" /  
 2 portes avec 2 tablettes ajustables.

All birch veneer buffet / 3 drawers with "quadro slides" /  
 2 doors with 2 adjustables wood shelf.

**8750**

LARGEUR WIDTH	PROFONDEUR DEPTH	HAUTEUR HEIGHT
52"	16 <sup>1</sup> / <sub>4</sub> "	36"